

MIMMS ENTERPRISES  
 85-A MILL ST.  
 ROSWELL, GA 30075  
 770-518-1100

THUNDERHEAD DISTRIB  
 6899 PTREE IND BLVD  
 SUITE N  
 CHAMBLEE, GA

SPACE PLAN

DRAWN  
CFS  
 CHECKED  
 DATE  
9/8/2004  
 SCALE  
AS SHOWN  
 JOB NO.  
MIMMS4210  
 SHEET

A-1

1 OF SHEETS 1

- MAIN ELECTRICAL ROOM:
- \* HVAC
  - \* TWO (2) 150A, 120/208V ELECTRICAL SUBPANELS
  - \* 60A, 600V MAIN BREAKER
  - \* STEP-DOWN ELECTRICAL TRANSFORMER

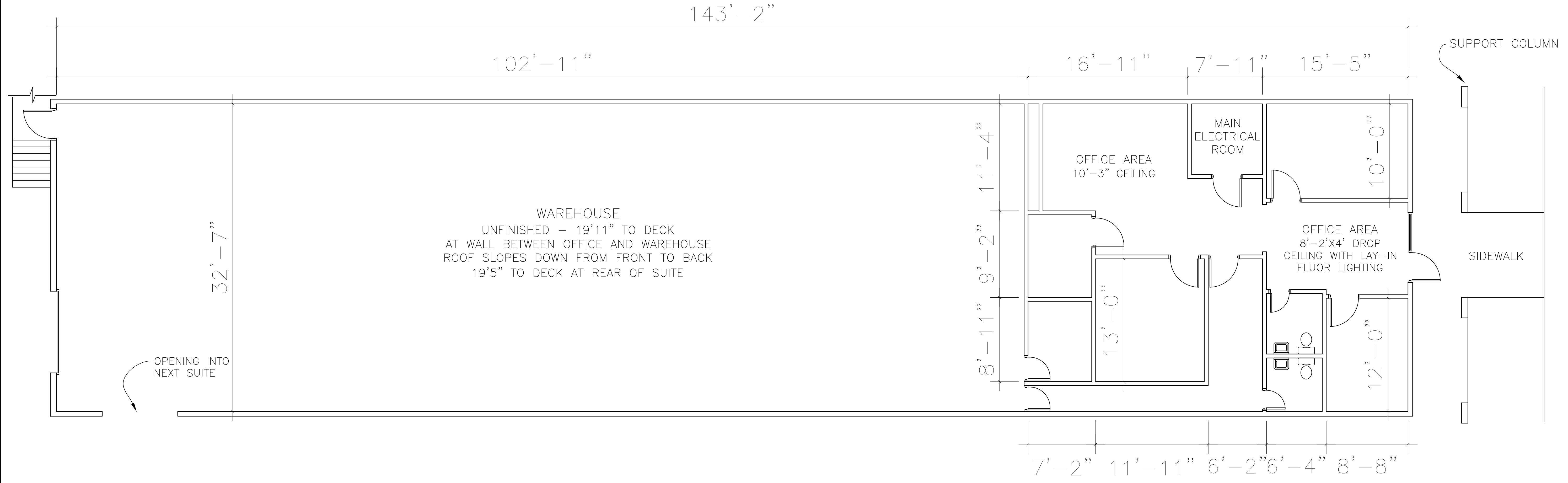

EXISTING FLOOR PLAN:  
 SCALE: 3/16" = 1'

NOTE: DIMENSIONS ARE FOR INTERIOR REFERENCE ONLY, AND DO NOT REFLECT TOTAL SUITE SQUARE FOOTAGE.