

MIMMS ENTERPRISES  
780 OLD ROSWELL PLACE, SUITE 100  
ROSWELL, GA 30076  
770-518-2200

SUITE 103  
2070 PEACHTREE INDUSTRIAL COURT  
CHAMBLEE, GEORGIA

FLOOR PLAN

DATE  
JAN. 13, 2014  
SCALE  
AS SHOWN

JOB NO.  
SHEET  
A-1

1 OF SHEETS

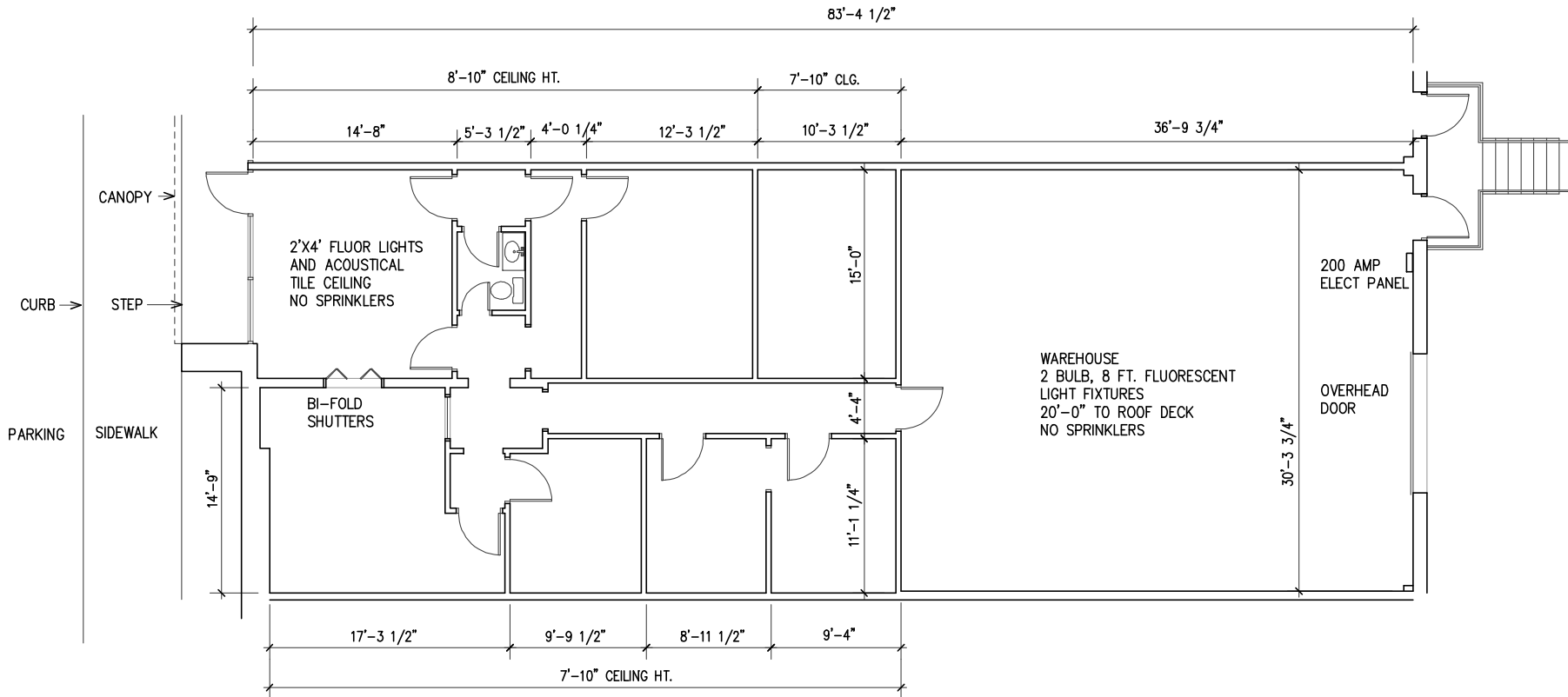

FLOOR PLAN

