

MIMMS ENTERPRISES
780 OLD ROSWELL PLACE, SUITE 100
ROSWELL, GA 30076
770-518-2200

SUITE 211
2065 PEACHTREE INDUSTRIAL COURT
CHAMBLEE, GEORGIA 30341

FLOOR PLAN

DATE
OCT. 4, 2016

SCALE
AS SHOWN

SHEET
A-1
1 OF SHEETS

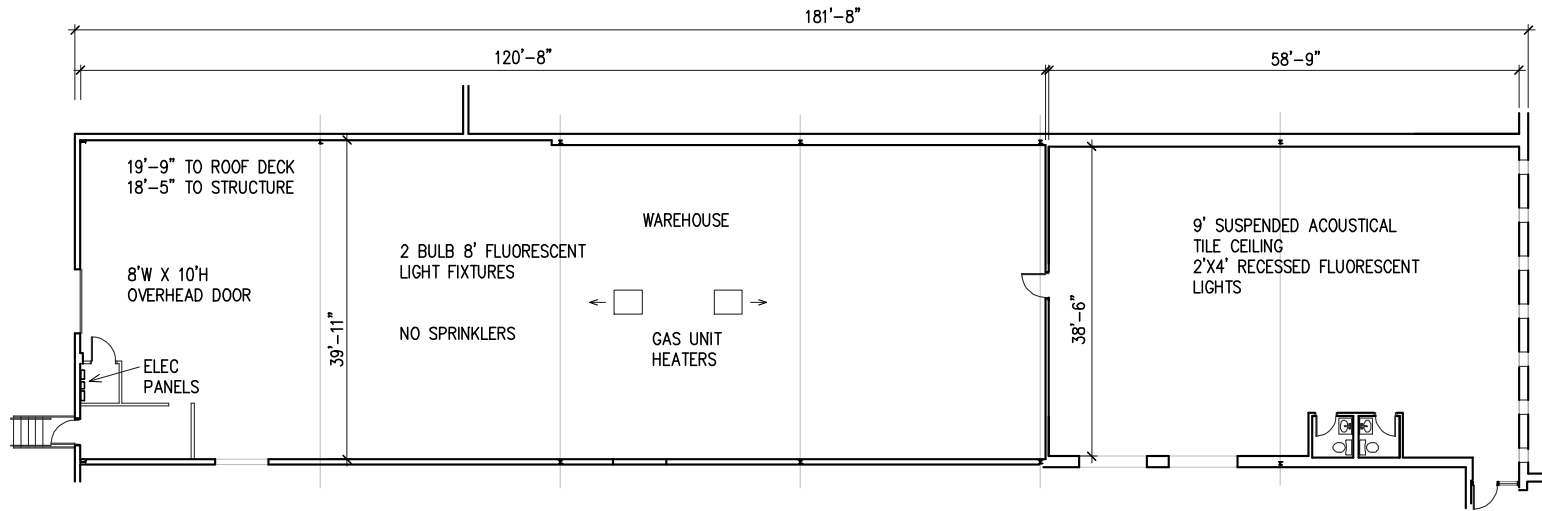

FLOOR PLAN

0' 4' 8' 12' 16' 20'
| | | | |